

Facilitator Shopping Center





Systemair - Ventilation World Wide

Systemair is a leading ventilation company with sales companies in 40 countries in Europe, North & South America, Asia, the Middle East, South Africa and Australia.

We have 15 production facilities located in; Sweden, Norway, Denmark, Germany, Slovenia, Slovakia, Lithuania, Spain, India, Malaysia, USA and Canada, with a total production and warehouse area of more than 190 000 sqm. Sales amounted to approx. SEK 3.47 billion for the fiscal year 2010/2011 and the Group employs over 2500 people worldwide.

Since October 2007 Systemair is listed on the OMX Nordic Exchange in Stockholm.

Our testing laboratory and development center are among the most modern within the ventilation industry in Europe, accredited by AMCA.

Systemair is certified in accordance with ISO 9001 and ISO 14001 accredited test laboratory we can guarantee that catalogue data is accurate.

Business concept

Operating from the core values of simplicity and reliability, our mission is to develop, manufacture and market high-quality ventilation products.

Core values

Systemair operates from core values of quality, availability and delivery reliability, with the customer at the centre.

Sustainability for us means responsibility and quality – in our business activities, environmental efforts, and for personnel and in our civil life.

Our ethics policy is a foundation for our business activities and our environmental work.

Business activities

High-quality products with a long service life have the least environmental impact over time. Our development resources focus on products with low energy consumption.

Built-in quality consciousness

We have a process-led business system, and quality consciousness is built into our mission statement and our values. The “Constant Improvement” project, a tool to monitor and improve operations, is in operation at all times.

Every product is always tested before delivery, and with our own AMCA

Suppliers

Systemair’s suppliers shall be evaluated and selected based on their ability to deliver on sound commercial terms and their ability to live up to Systemair’s code of

conduct. We do not accept products from suppliers who use child labour directly or indirectly through their subcontractors.



Logistics flows

We are working on coordinating our production at our main plants and closing the smaller production plants. This will result in higher capacity utilisation in existing plants, savings and more efficient logistics. This in turn will reduce our environmental impact.

No impact on air or water

Systemair develops energy-efficient products that create a good indoor environment. Our production has no impact on air or water. Neither are we subject to compulsory environmental licensing, only a duty of notification. Nevertheless, environmental issues and environmental activities are a high priority, and we are continuously improving our products, methods and working practices to minimise the burden on the environment. Our products are recyclable and our components environment friendly.



Facilitator Shopping Center

The intention with "facilitator shopping centers" is to give you an example of products, that generally works well in the installations in a shopping center. The products shown, we know works generally well together and put together in the right combinations, you will gain some interactions which will, in the end, result in an energy efficient installation. With the right design it will also create a good indoor air quality (IAQ) and this will reflect on the productivity.

Ventilation, heating and cooling of shopping centers are one of the most demanding task for a designer due to the variety of activities. Often there are many light sources which generates in total huge amounts of heat that need to be taken care of. To solve this issue there are several solutions depending on the construction of the building.

At the same time, installations has to be flexible due to the fact that shops tends to move more or less often and by this new business are brought in to areas where there is a different need.

Saving cooling and heating by using different types of controls are over the years a good investment and the pay-back time is relatively short. On next page you see a list of products commonly used in shopping centers installations.



Products for all applications

We cover all your needs with our products and optimise your solutions

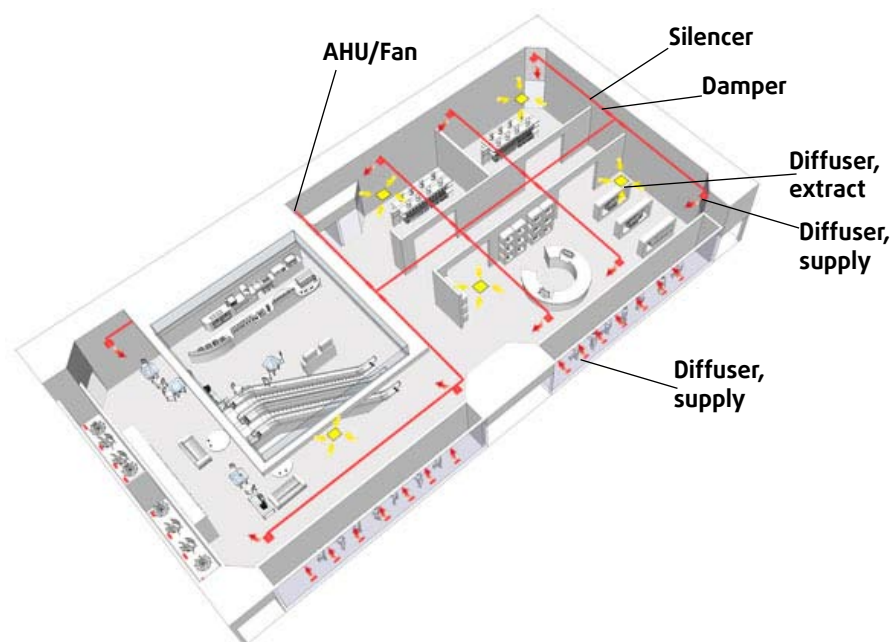

MUB-EC



The Multiboxes MUB-EC are driven by EC-external rotor motors. The power electronics are integrated in the motor housing. MUB-EC can be used as fan module in individual supply or exhaust air applications.

Roof fan DVV...F400/600



Smoke-extract roof unit. Max air flow 55 000 m³/h. Certified for 400°C/120 min and 600°C/120 min.

DHS-DVS/DVSI



The DVS/DHS models have impellers with backward-curved blades and external rotor motors. The casings are made from seawater resistant aluminium and the base frame is powder-coated galvanised steel. Also available with tilting device. DVSI with 50 mm mineral wool insulation for low noise level.

Axial fan AXC...F300/F400



AXC fans are available in duct mounted versions as well as roof (D) and plate mounted (P). Max air flow 180 000 m³/h. Certified for 300°C/120 min. and 400°C/120 min.

TA



Compact supply air unit for circular/rectangular ducting suitable for supplying air to smaller buildings. Max airflow 14 000 m³/h. Accessories: Supply air damper, cooling battery.

IV - Radial Jet fan

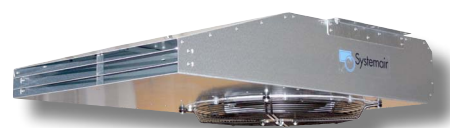

Induction Fan in compact casing with high efficiency radial fan with revision switch (optional). Using for horizontal construction. All steel parts are hot-dip galvanized, for best corrosion protection. IEC standard motors, insulation class H, enclosure class IP55. Systemair induction fans have been tested in accordance with EN 12101-3 and are CE labelled.

Suitable products for interaction in shopping center installations

DV



The DV, air handling units (AHU) are highly flexible AHU's that can be configured to make up the heart of any mechanical ventilation system.

The DV comes in a range of 12 different sizes with air volume capacities from 1500 m³/h to 85 000 m³/h, making it possible to always find the unit suitable for any requirement.

PK-I-R/PK-I-S

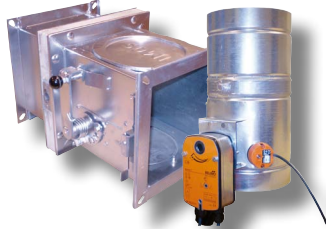

Systemair Fire dampers are manufactured and certified to latest European Standards EN1366-2. With wide products range and sizes for 60, 90 and 120 min resistance for round and 90 and 120 minutes resistance for rectangular ducting.

PK-I-R: ø100 mm to ø1000 mm
PK-I-S: 100x100 mm to 1600x1000 mm

Topvex



Topvex is a "Plug and play" air handling unit with a modern design. Top connection of the air-ducts minimize the "Footprint" of the unit. To meet the new restricted energy requirements with low SFP (Specific Fan Power) Topvex is equipped with EC fan motors. EC-motors consume an average of 30% less energy than AC motors with its crossflow and rotary heat exchanger is normally used where it is a requirement that the supply and exhaust air must be kept separated. The units have an efficient deicing function.

Sinus-A



Adjustment of air pattern possible with nozzle diffusers.

AJD



Flush jet diffuser

Konika-A



Multi cone diffuser

VVKN-B-Q

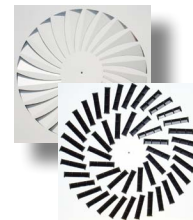

VVKR-Q
Ceiling swirl diffuser



Ceiling diffuser

AHU = Air Handling Unit
ADP = Air Distribution Product
F&S = Fire and Smoke

Shopping Center

Fans	Circular duct fans	K/KV
		RVK
	Insulated box fans	KD
		KVK
		KVKE
		RS/RSI
	Radial fan	KE/KT
	Box fan	MUB
	Axial fan	AR/AW
	Roof fan	AXC
		DVS/DVSI
		TOE/TOV
Smoke extract fans	DVC	
	DVV	
	KBR/F	
	AXC	
AHU	Air handling units	DV
		Time
		Topvex
ADP	Air valves	EFF
		DVX
		OVE-OVR
	Wall grilles & diffusers	NOVA-A
		NOVA-R
		NOVA-F
	Linear wall & ceiling diffusers	CSF
		NOVA-L
	Transfer & door grilles	NOVA-E
	Duct mounted grilles & diff.	NOVA-C
		Sinus-DC
		Sinus-DR
	Square ceiling diffusers	Kvadra
		VVKN
		VVKR
		TSF
		TSO
	Round ceiling diffusers	Konika
		Konika-A
		CRS
		CRS-T
		TST
		TSK
		TSR
		TSP
		VVKN-K
		VVKR-K
Sinus-C		
Sinus-C/T		
IKD		
TSD		
Jet diffusers	AJD	
	JSR	
	ADL	
Air volume contr.	SPI	
External louvres	IGC	
	IGK	
Chilled beams	Stratus	
	Cirrus	
F & S	Fire dampers	PKI-R

